

LED导光柱 LED PIPE



用途：使LED导光于机壳面板上，使光度均匀、柔和。

MATERIAL : PC(UL)

FLAME CLASS : 94V-0,94V-2

COLOR : TRANSPARENT

UNIT : mm

2

PART NO	L	PACKAGE
LEDLP-212	4.8	1000
LEDLP-213	5.0	1000
LEDLP-214	8.0	1000
LEDLP-237	10.0	1000
LEDLP-238	7.0	1000

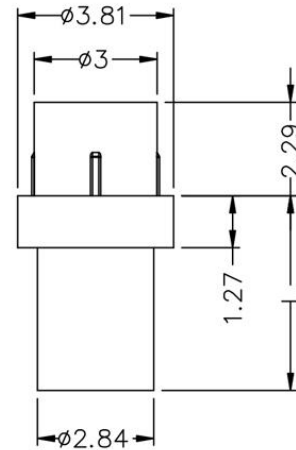

MOUNTING HOLE $\phi 3.05$

LED导光柱 LED PIPE



用途：使LED导光于机壳面板上，使光度均匀、柔和。

MATERIAL : PC(UL)

FLAME CLASS : 94V-0

COLOR : TRANSPARENT

UNIT : mm

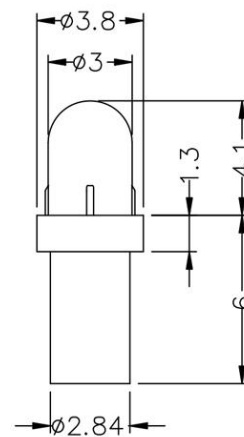

MOUNTING HOLE $\phi 3.0$

PART NO	PACKAGE
LEDLP-215	1000